

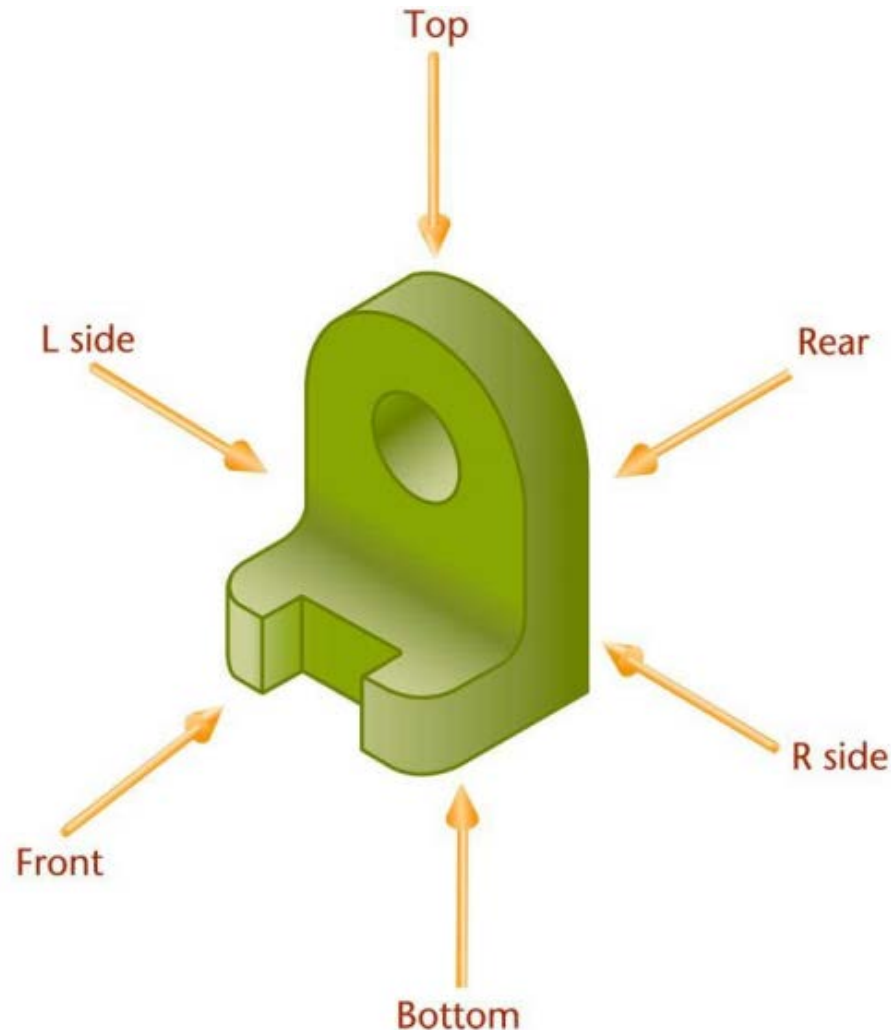

Views of Objects

The Six Standard Views

- Any object can be viewed from six mutually perpendicular views:



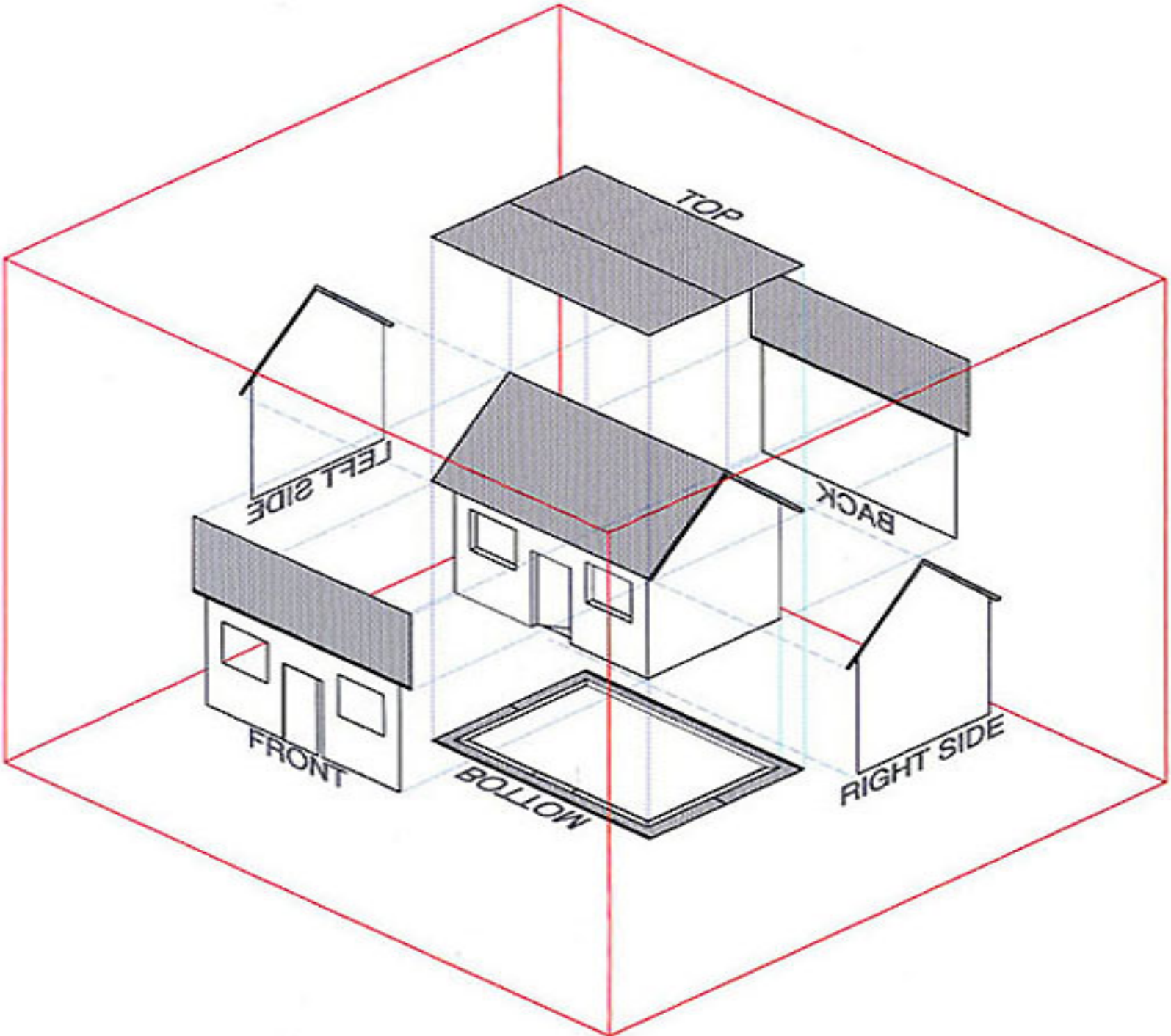

Standard 2D views

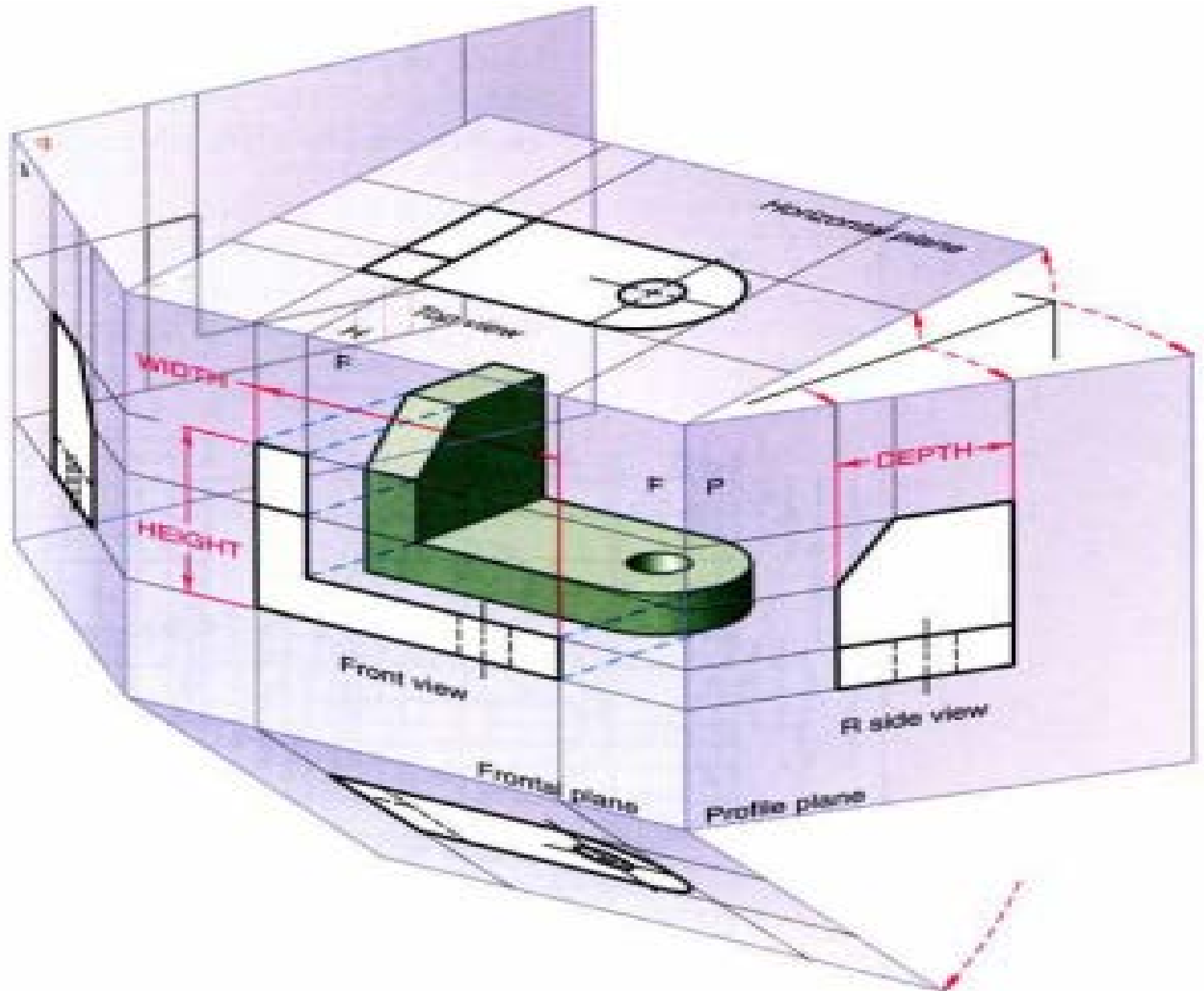

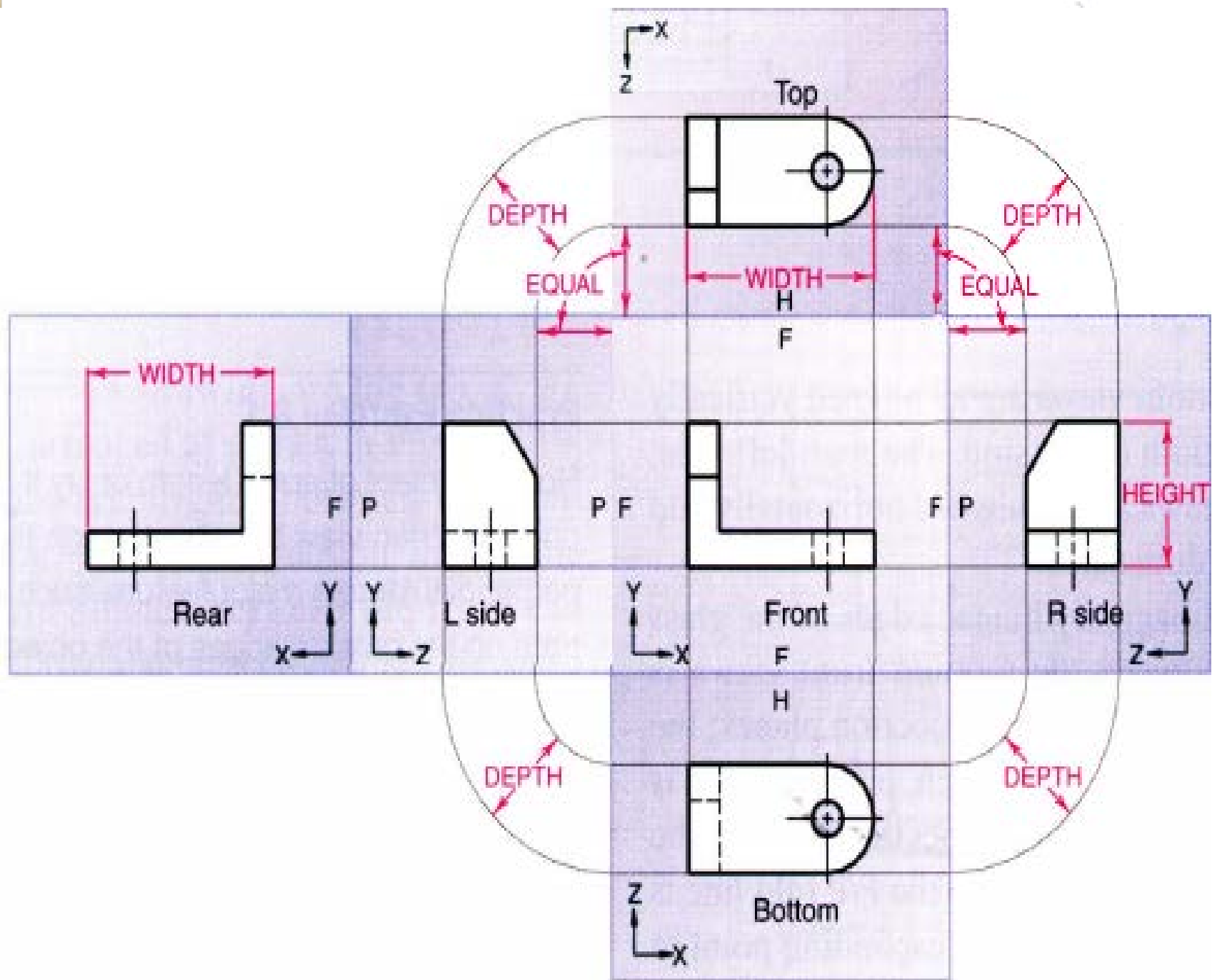

Principal Dimensions

The three principal dimensions of an object are:

- Width
- Height
- Depth

Any principal view shows two of the three principal dimensions

Height is shown in the rear, left-side, front, and right side.

Width is shown in the rear, top, front, and bottom.

Depth is shown in the left-side, top, right-side, and bottom views.

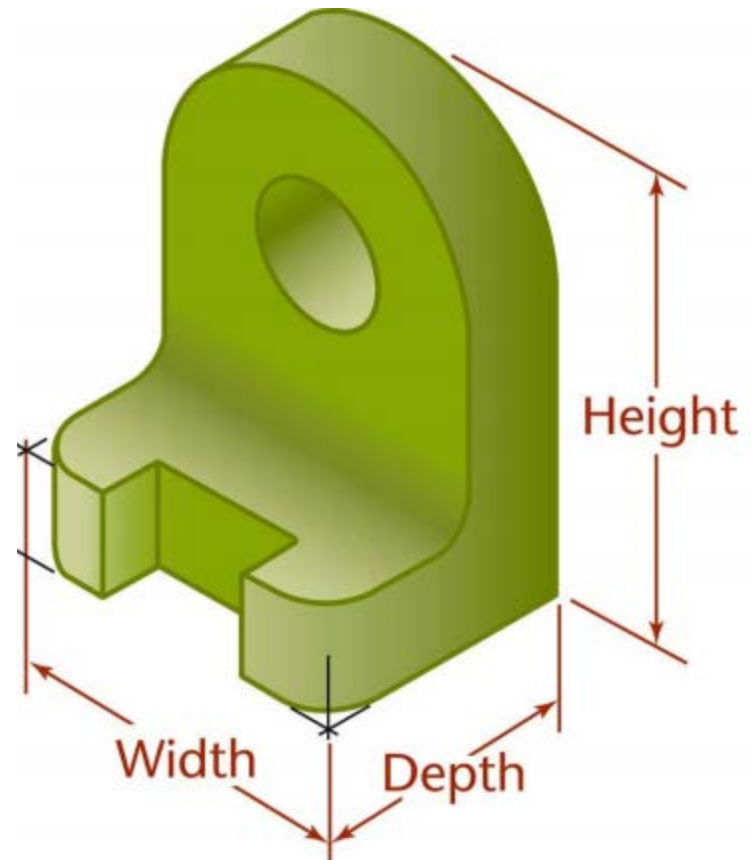

Top view of
projection line

Top view

Horizontal plane

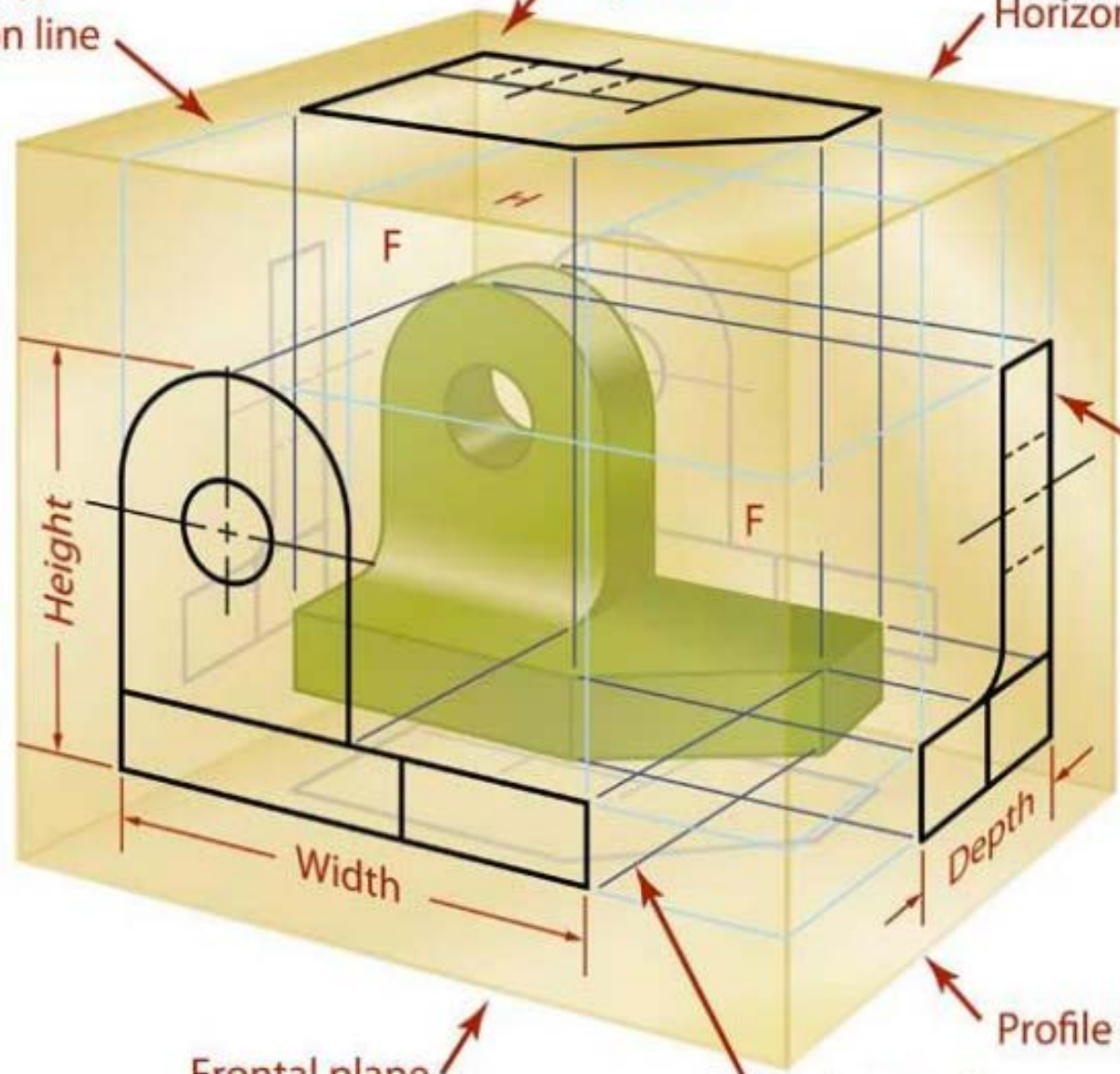

Right side view

Height

Width

Depth

Frontal plane

Profile plane

Projection line

First-and Third-Angle Projection

There are two main systems used for projecting and unfolding the views:

- **Third-angle** projection which is used in the United States, Canada and some other countries.
- **First-angle** projection which is primarily used in Europe and Asia.

Third-angle Projection

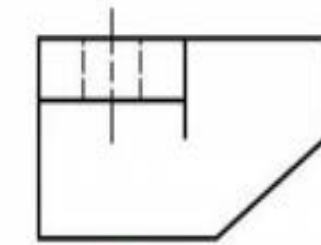
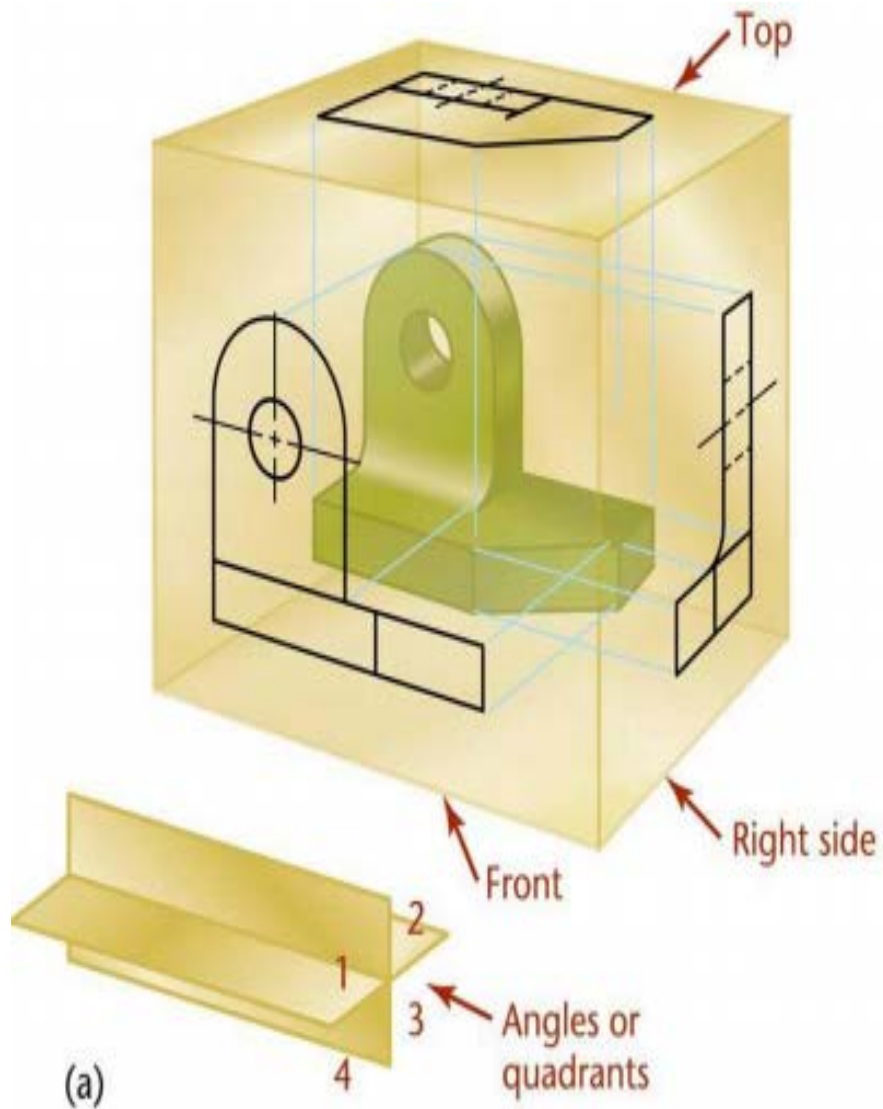

Top view

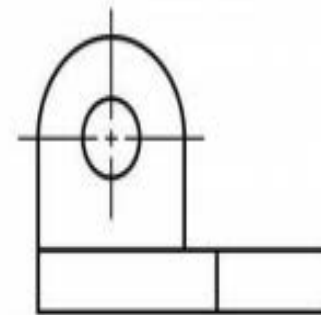

Front view

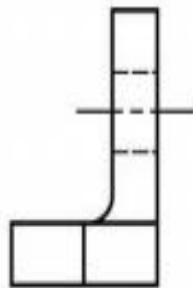

R side view

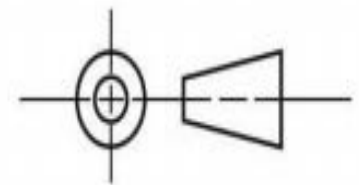

(b) Third angle projection symbol

First-angle Projection

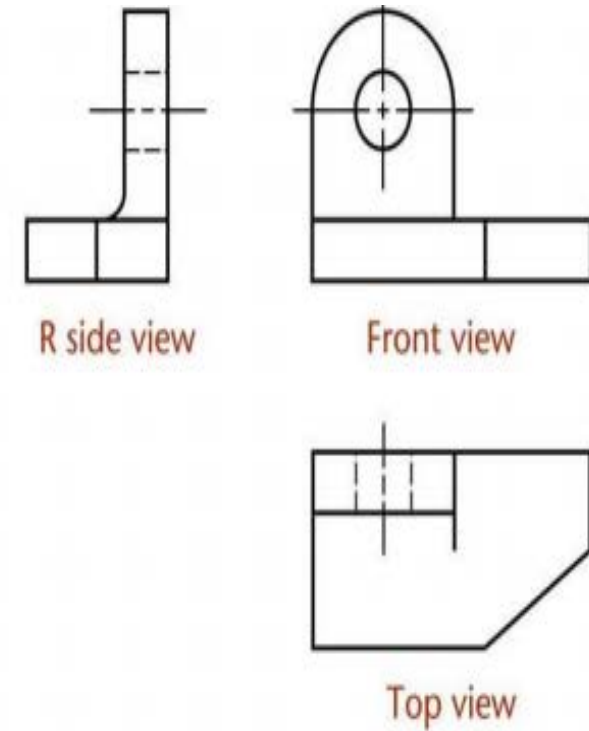
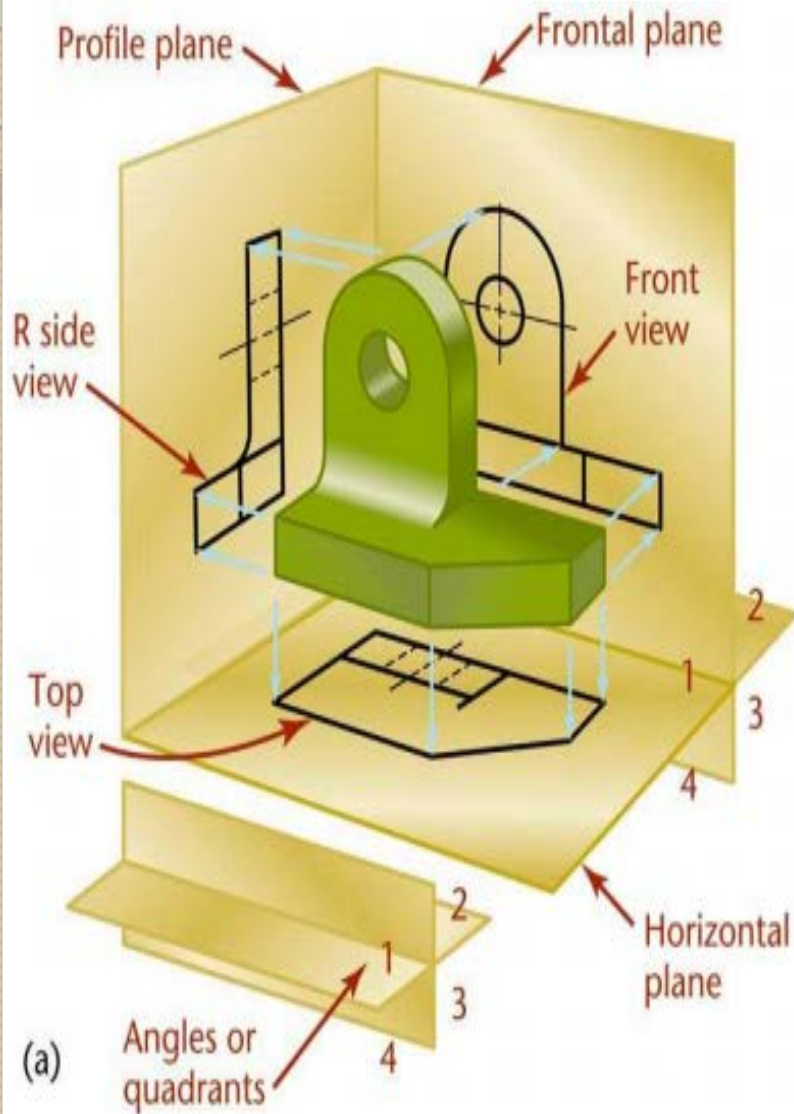

(b)

